

Gas charging description

1. Gas charging indication:
LED 2 blue and yellow light flashes,
5 times every 10 seconds;
2. Gas charging process:
 - (1) Shutdown the device;
 - (2) Insert the gas cylinder vertically into the gas inlet;
 - (3) The time for gas charging is about 10 seconds;
3. The number of sprays after filling up the gas:
 - (1) small volume: about 60 times;
 - (2) large volume: about 30 times;

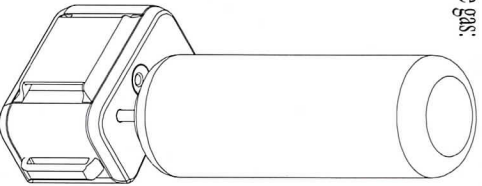

Reminder

A small number of dogs will display irritability when wearing a spray bark stopping device, and are confused about spray warnings or uncertain how to avoid. At this time, you need to gently guide and comfort your pet. Use proper methods to guide the dog to adapt to spray warnings. After several guidance, the dog will adapt quickly.

1. This device is suitable for all large, medium and small dogs and shall not be used for any other purpose not described in this manual.
2. Too long use of the device on dogs can cause a condition similar to bedsores, i.e. compressive skin necrosis. To reduce this possibility, please refer to following methods:
3. Regularly check whether there is any rash or pain anywhere on the neck of the dog;
4. After the dog is put on the device, please monitor your dog within the first one or two days;
5. Make real-time inspection of the device to prevent excessive pressure, and one finger should be able to be placed between the device and the dog's neck;
6. Regularly scrub around the dog's neck and the device's sensor head weekly;
7. Do not attempt to remove or repair any parts of the device, which otherwise will make the warranty invalid;
8. If your dog has extreme resistance or dangerous movement against wearing this device, stop using it immediately after the guidance is invalid;
9. We recommend the use of this device for dogs aged six months and weight over 8 pounds;
10. This device should not be used continuously for 12 hours within 24 hours.



Friendly Tips

The correct manual testing method for spray bark collar. Make sure the device is turned on and "Shout in a row" at the receiving hole on the back of it, if it sprays, it's good.

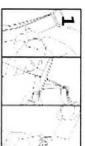

1. Wear the bark-stopping device on the dog, adjust the collar belt according to the size of the neck of the dog, and remove the remaining part of the collar. Correct wearing is the prerequisite for effective use.

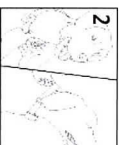

2. Wear the bark-stopping device on the neck of the dog and install it well, with the spray nozzle aligned perpendicularly to the dog's nose, and the wearing criterion is based on the extent that one finger can be accommodated between the collar and the dog's neck. This can accurately identify the frequency of the dog's barking. Installation is very important. Too much relaxation of the device installation will lead to uncoordinated action and affect the normal operation of the product.



3. For a dog with long hair, it is necessary to trim the hair on the spray path to ensure that the mist can be sprayed to an effective range.

