



# NoBark 6 Operating Guide

Please read this entire guide before beginning



Thank you for choosing SportDOG Brand™. Used properly, this product will help you train your dog efficiently and safely. To ensure your satisfaction, please review this operating guide thoroughly. If you have questions regarding this product's operation contact our Customer Care Center at 1-800-732-0144, or visit our website at [www.sportdogbrand.com](http://www.sportdogbrand.com).

Please register your product within 90 days at [www.sportdogbrand.com](http://www.sportdogbrand.com) or by mailing in the registration card. By registering, you will enjoy the product's full warranty and should you ever need to call the Customer Care Center, we will be able to help you faster. Additionally, you will not have to save your product receipt as registering serves as proof of purchase. Most importantly, SportDOG will never give or sell your valuable information to anyone.

---

## Table of Contents

Components .....	3
How the SportDOG NoBark 6 Works.....	3
Key Definitions.....	4
To Insert and Remove the Battery .....	5
To Test the NoBark 6 .....	7
To Fit the NoBark 6.....	8
Regular Maintenance .....	9
What to Expect During Use of the NoBark 6.....	10
Accessories .....	11
Frequently Asked Questions.....	12
Troubleshooting.....	14
Service.....	15
Terms of Use and Limitation of Liability .....	15

## Components



### **How the SportDOG NoBark 6 Works**

The SportDOG NoBark 6 effectively and humanely stops barking when it is worn. When the vibration of your dog's bark triggers the Vibration Sensor Probe, a Static Correction is administered through the Contact Points. The NoBark 6 starts with the lowest level of Correction and then increases through 6 levels each time your dog barks within 30 seconds of the previous bark. If your dog does not bark again within 30 seconds, the NoBark 6 will reset itself to the lowest level of Correction. Along with each Correction, there will be an audible beep. As an added safety feature, the NoBark 6 will automatically shut off for 3 minutes if your dog barks 15 times or more within a 50-second period.

## Important:

- **DO NOT** use the NoBark 6 with any additional collars, tags, leashes or other items that may cause vibration and trigger a false correction.
- Your dog may wear a harness for attaching a leash and/or tags while using the NoBark 6.
- Before playing with your dog, remove the NoBark 6. The activity may cause your dog to bark, which could lead to him associating the play with the Correction.
- Never leave the NoBark 6 on for more than 12 consecutive hours.

## Key Definitions

**Contact Points:** Deliver the safe Correction.

**Vibration Sensor Probe:** Detects the vibrations of your dog's barking. **Important: The Vibration Sensor Probe is not adjustable.**

**Low Battery Indicator:** The Indicator light will begin flashing when battery is low.

Contact Points

Vibration Sensor Probe



RFA-67 Battery

Low Battery Indicator

## To Insert and Remove the Battery

*Note: Do not install the battery while the NoBark 6 is on your dog.*

This NoBark 6 utilizes a replaceable RFA-67 battery. This unique battery is designed to make battery replacement easier and increase water protection.

### **To Insert the Battery:**

To insert the battery, align the symbols on the battery (arrow) and NoBark 6 (triangle). Use the Test Light Tool to turn the battery clockwise until the arrow lines up with the lock symbol on the housing.

### **To Remove the Battery:**

To remove the battery, turn the battery counter-clockwise using the Test Light Tool. **DO NOT** attempt to cut into or pry open the battery. Be sure to discard the used battery properly.

A replacement RFA-67 battery can be found at many retailers. Contact the Customer Care Center at 1-800-732-0144 or visit our web site at [www.sportdogbrand.com](http://www.sportdogbrand.com) to locate a retailer near you.

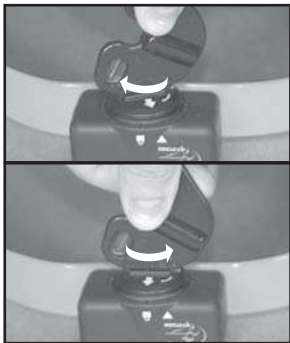

*Note: After battery removal, the NoBark 6 may activate 2 or 3 additional times. To ensure the NoBark 6 is deactivated, slide the Vibration Sensor Probe across a table or hard surface several times, until the NoBark 6 stops beeping.*

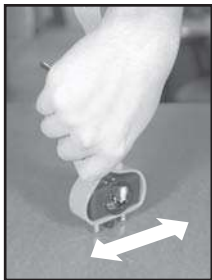

### **Battery Life**

Average battery life is 3 to 6 months, depending on how often your dog barks. However, due to greater use during your dog's training, your first battery may not last as long as replacement batteries.

### **Low Battery Indicator**

During normal operation the Indicator Light remains off. As the product is used, the battery will be drained to a weakened state. At this point, the Indicator Light will begin to flash to show that it is time to change the battery.

## To Test the NoBark 6

Slide the Vibration Sensor Probe across a rough surface for at least 10 inches. The NoBark 6 should beep. If your NoBark 6 doesn't beep during this test, see "The NoBark 6 does not beep" in the "Troubleshooting" section, and continue with the second step.

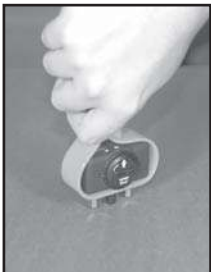

*Note: For further verification that the SBC-6 is functioning, place the contact points on the Test Light Tool and repeat the above procedure.*

## To Fit the NoBark 6

**Important: The proper fit and placement of your NoBark 6 is important for effective operation. The Contact Points must have direct contact with your dog's skin on the underside of his neck.**

To assure a proper fit, please follow these steps:

1. Make sure that the battery is not installed in the NoBark 6.
2. Start with your dog standing comfortably.
3. Place the NoBark 6 high on your dog's neck close to the ears. Center the Contact Points underneath your dog's neck, touching the skin.



*Note: It is sometimes necessary to trim the hair around the Contact Points to make sure that contact is consistent.*

4. Check the tightness of the NoBark 6 by inserting one finger between the end of a Contact Point and your dog's neck. The fit should be snug but not constricting.
5. Allow your dog to wear the NoBark 6 for several minutes then recheck the fit. Check the fit again as your dog becomes more comfortable with the NoBark 6.

**Important: Never leave the NoBark 6 on for more than 12 consecutive hours.**



**Important: For comfort, safety and effectiveness of product, please ensure the following:**

- **Check the fit to prevent excessive pressure by being able to insert one finger between a Contact Point and your dog's skin.**
- **Examine your dog daily for any signs of a rash or sore.**
- **If a rash or sore is observed, discontinue the use of the NoBark 6 for a few days.**
- **If the condition persists beyond 48 hours, see your veterinarian.**
- **Your dog's neck and the Contact Points must be washed weekly with a wash cloth and mild hand soap, then rinsed thoroughly.**

**A condition called Pressure Necrosis, which is a devitalization of the skin due to excessive and prolonged contact against the Contact Points, may occur if the steps above are not followed.**

---

## **Regular Maintenance**

- **Check your dog's neck for irritation (daily).**
- **Check fit of NoBark 6 on dog (daily).**
- **Check Battery for proper fit in NoBark 6 (weekly).**
- **Check Contact Points for tightness, finger tight plus  $\frac{1}{4}$  turn with pliers (weekly).**
- **Clean Contact Points and wash neck (weekly).**

## What to Expect During Use of the NoBark 6

**Important: Do not leave your dog alone the first few times he receives a Correction.**

Place the NoBark 6 properly on your dog and wait nearby until he barks. Most dogs will understand very quickly that the NoBark 6 is disrupting their urge to bark and will relax and stop barking. Because the Correction from the NoBark 6 may be surprising or startling at first, some dogs may bark more at the initial correction.

On rare occasions, a dog may get into a bark-correction-bark-correction cycle. If this happens, reassure your dog with calm, soothing tones. As your dog relaxes, he will understand that if he becomes quiet, he will not receive any more Corrections. The small minority of dogs that have this reaction will only have it the first time they wear the NoBark 6.

You should notice a reduction in your dog's barking within the first couple of days that he wears the NoBark 6. At this point, it is important to remember the learning process is still not complete. Dogs will "test" this new learning experience and will increase their attempts to bark. This usually occurs during the second week a dog wears the NoBark 6. If this does occur, remain consistent and do not alter your use of the NoBark 6. You must place the NoBark 6 on your dog in every situation when you expect him to be quiet. If your dog is not wearing the NoBark 6, he may resume barking and his learning would suffer a setback.

## Accessories

To purchase additional accessories for your SportDOG NoBark 6, contact the Customer Care Center at 1-800-732-0144 or visit our website at [www.sportdogbrand.com](http://www.sportdogbrand.com) to locate a retailer near you.

<b>Component</b>	<b>Part Number</b>
Battery - two pack	RFA-67D-11
Replacement Collar	RFA-68
Accessory Pack (Extra Contact Points, washers, and battery)	RFA-118

## Frequently Asked Questions

<b>Will my dog stop barking completely?</b>	<ul style="list-style-type: none"><li>• The NoBark 6 effectively and humanely stops barking when it is worn. It should only be worn during periods of unwanted barking.</li></ul>
<b>My dog has a sensitive nature. Can I lower the Correction level?</b>	<ul style="list-style-type: none"><li>• You can obtain a resistor to reduce the Correction level by contacting the Customer Care Center at 1-800-732-0144.</li></ul>
<b>Will another dog's bark set off the NoBark 6?</b>	<ul style="list-style-type: none"><li>• No.</li></ul>
<b>Is the NoBark 6 safe and humane?</b>	<ul style="list-style-type: none"><li>• Yes. The NoBark 6 is designed to get your dog's attention, not to punish him. However, the initial Correction may startle your dog.</li></ul>
<b>Will the NoBark 6 work for my dog?</b>	<ul style="list-style-type: none"><li>• The NoBark 6 is safe and effective for all breeds and sizes of dogs, though it may be too large for dogs under 8 pounds to wear comfortably.</li></ul>
<b>Can I leave the NoBark 6 on my dog all the time?</b>	<ul style="list-style-type: none"><li>• No. Never leave the NoBark 6 on for more than 12 consecutive hours.</li></ul>

<b>Is it possible for my dog to learn not to bark only when the NoBark 6 is on?</b>	<ul style="list-style-type: none"><li>• Yes. This is best accomplished by placing the NoBark 6 on your dog only in situations where you never want him to bark, and never placing the NoBark 6 on your dog in situations where you find it acceptable for him to bark.</li></ul>
<b>I have more than one dog, but only one dog with a barking problem. Will it cause problems between the dogs if I keep them together?</b>	<ul style="list-style-type: none"><li>• It should not be a problem, especially if you follow the procedures described in this guide.</li></ul>

## Troubleshooting

**The NoBark 6 does not beep.**

- Test the NoBark 6 (see “To Test the NoBark 6” section).
- If your NoBark 6 does not beep during this test, try the same test on a rougher surface.
- Ensure that the battery is properly installed.
- Replace the battery.
- If the NoBark 6 still does not beep, contact the Customer Care Center at 1-800-732-0144.

**My NoBark 6 beeps, but my dog keeps barking (does not respond to the Correction).**

- Tighten the NoBark 6 and/or trim your dog’s hair where the Contact Points touch his neck to ensure good skin contact.
- Replace the battery.
- If your dog still does not respond, contact the Customer Care Center at 1-800-732-0144.

**The NoBark 6 Indicator Light is flashing.**

- Replace the battery

## **Service**

If you need service, please contact the Customer Care Center at 1-800-732-0144 for help in troubleshooting and, if necessary, to arrange a repair for your product (a service charge may apply). Also, please visit our website at [www.sportdogbrand.com](http://www.sportdogbrand.com) for more Frequently Asked Questions and Troubleshooting Tips.

---

## **Terms of Use and Limitation of Liability**

### **1. Terms of Use**

This Product is offered to you conditioned upon your acceptance without modification of the terms, conditions and notices contained herein. Usage of this Product implies acceptance of all such terms, conditions, and notices.

### **2. Proper Use**

This Product is designed for use with dogs where training is desired. The specific temperament of your dog may not work with this Product. We recommend that you not use this Product if your dog is less than 8 pounds or if your dog is aggressive. If you are unsure whether this is appropriate for your dog, please consult your veterinarian, certified trainer or contact our Customer Care Center at 1-800-732-0144.

Proper use includes reviewing the entire Operating and Training Guide provided with your Product and any specific Caution statements.

### **3. No Unlawful or Prohibited Use**

This Product is designed for use with dogs only. This dog training device is not intended to harm, injure, or provoke. Using this Product in a way that is not intended could result in violation of Federal, State or local laws.

#### **4. Limitation of Liability**

In no event shall Radio Systems® Corporation be liable for any direct, indirect, punitive, incidental, special or consequential damages, or any damages whatsoever arising out of or connected with the use or misuse of this Product. Buyer assumes all risks and liability from the use of this Product.

#### **5. Modification of Terms and Conditions**

Radio Systems Corporation reserves the right to change the terms, conditions and notices under which this Product is offered.

---

## **Perchlorate Battery**

Perchlorate Material – special handling may apply. See [www.dtsc.ca.gov/hazardouswaste/perchlorate](http://www.dtsc.ca.gov/hazardouswaste/perchlorate).

Radio Systems Corporation  
10427 Electric Avenue  
Knoxville, TN 37932  
1-800-732-0144  
[www.sportdogbrand.com](http://www.sportdogbrand.com)  
400-645/1

Protected by Patents #D515,027 #6,921,089  
and other patents pending.

©Copyright 2006 Radio Systems Corporation